

gabriel ash

Erection and Glazing Instructions

Gabriel Ash
Monument Farm
Farndon
Chester
CH3 6QP

01829 271888

enquiries@gabrielash.com
www.gabrielash.com

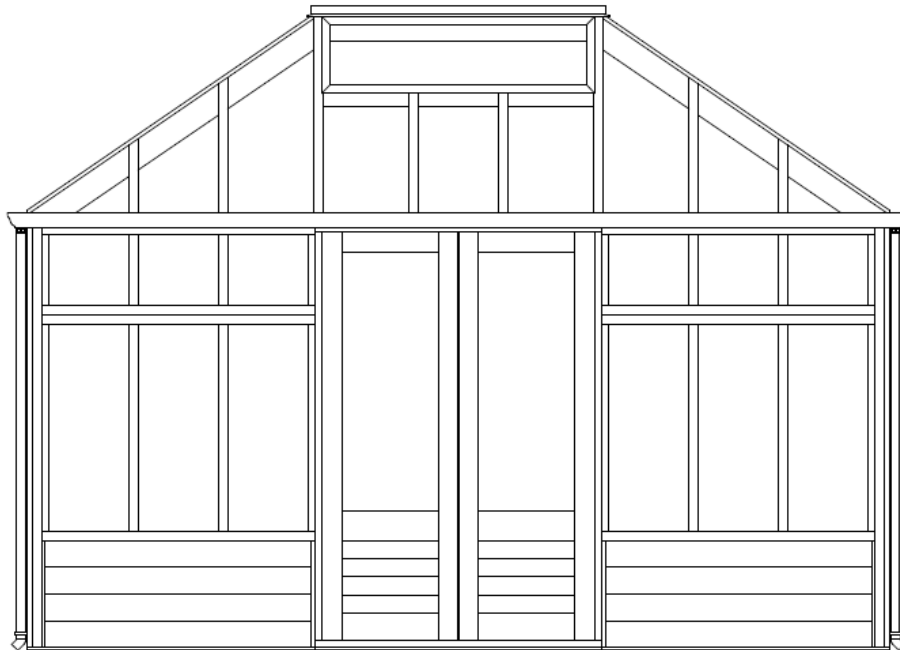

It is essential that these instructions are read carefully and the parts are examined and identified before construction begins.

The base on which the greenhouse is to be placed must be level and flat. An uneven foundation will lead to frustrating delays and subsequent disappointment.

Screw List

Images to Scale

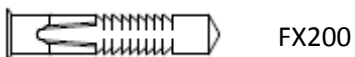
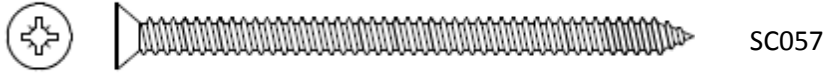
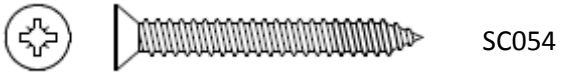

Fix Plain End Curtain Wall to Plinth and Corner Posts.

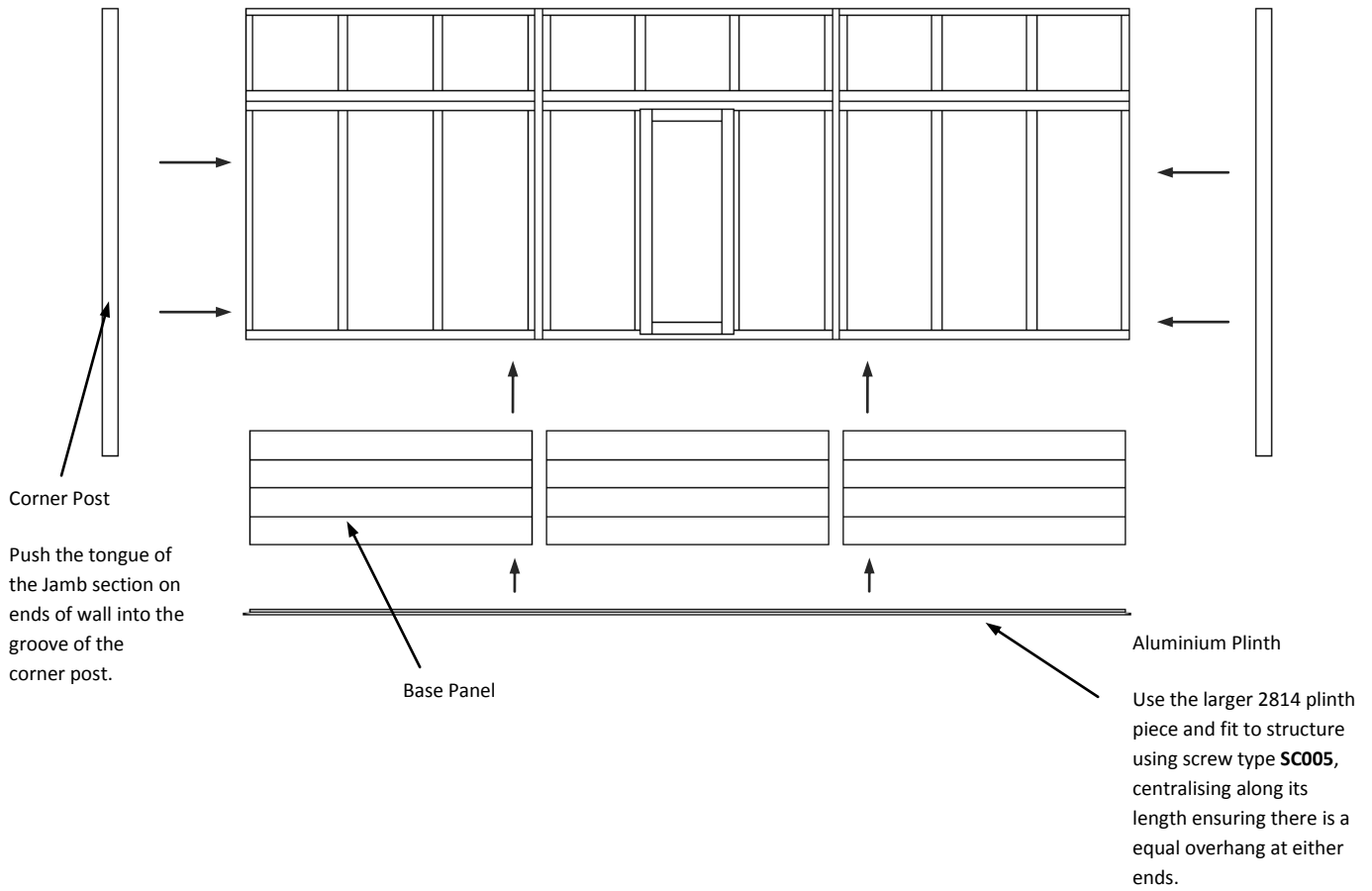

Fix base panel and curtain wall to corner post using screw type **SC027**.

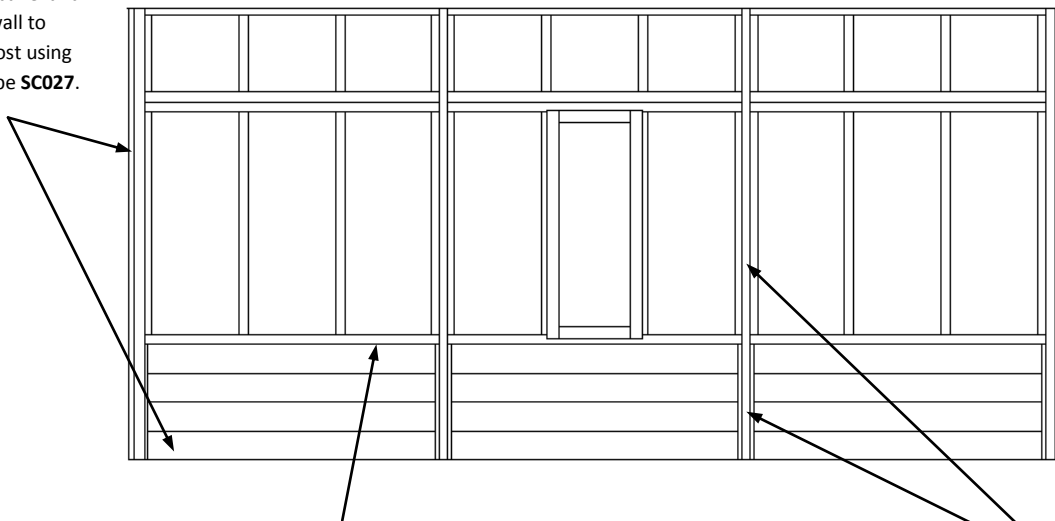

Fix base panel to curtain wall using screw type **SC055**.

Fix base panel and curtain wall to dividing post using screw type **SC025**.

Repeat for the Plain Sides fixing to the corner posts fitted in the previous instruction.

Door End

Repeat the previous instructions to fix the base panels and curtain wall to corner posts.

Fit the door into the appropriate aperture in the specific end of the structure.

The upright sections of the framework are tongued which locate into the grooves on the uprights of the door frame.

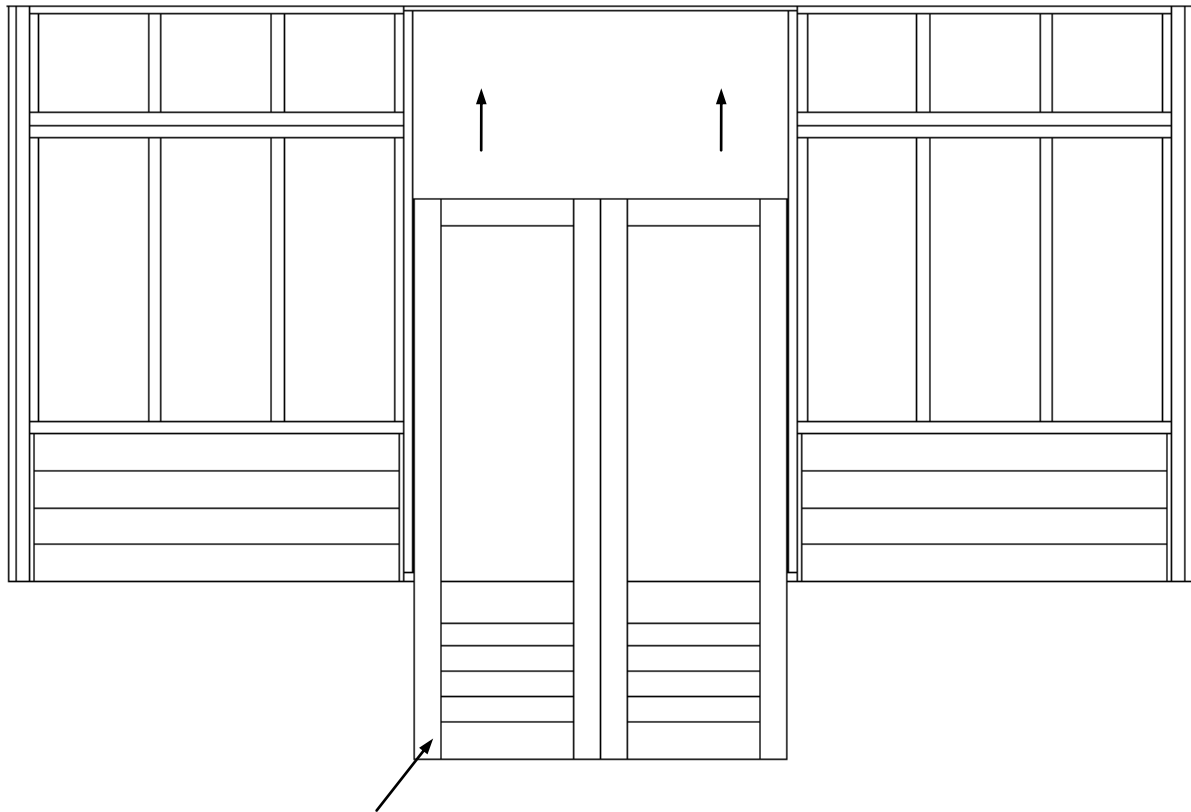

Slide the door into position until the head of the door frame fits against the head of the opening.

Fix through the pre-drilled holes into position using screw type **SC027**.

Fix Corner Fishplates to Curtain Walls

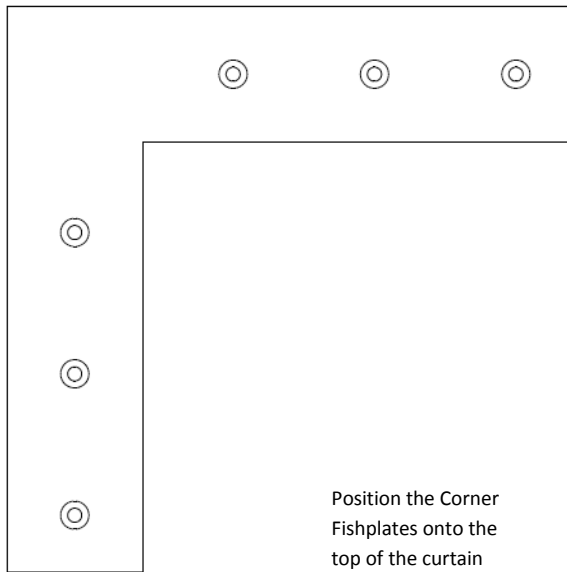

Position the Corner Fishplates onto the top of the curtain wall head sections and fix down using screw type **SC052**.

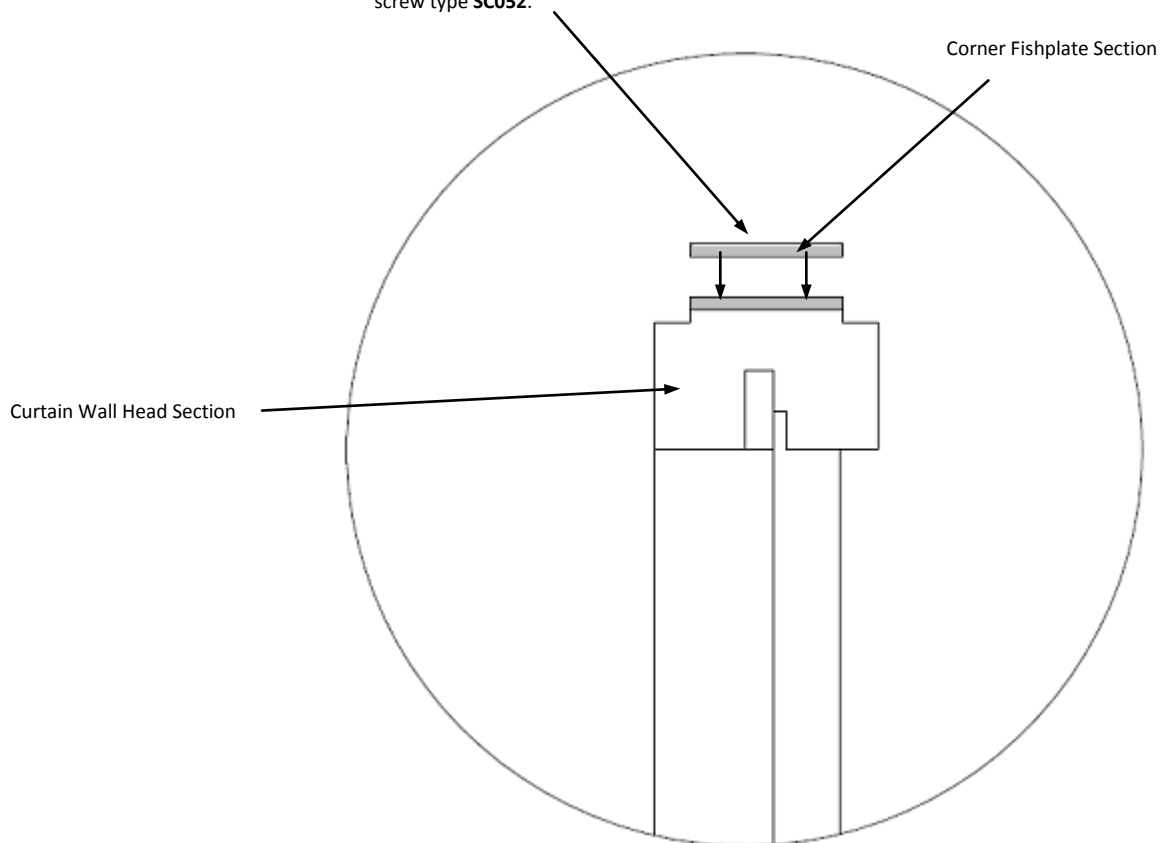

Fix Roof Section Wall Plates

Fix the Roof Section Wall Plate using screw type **SC055** through the pre drilled holes and into the curtain wall head section.

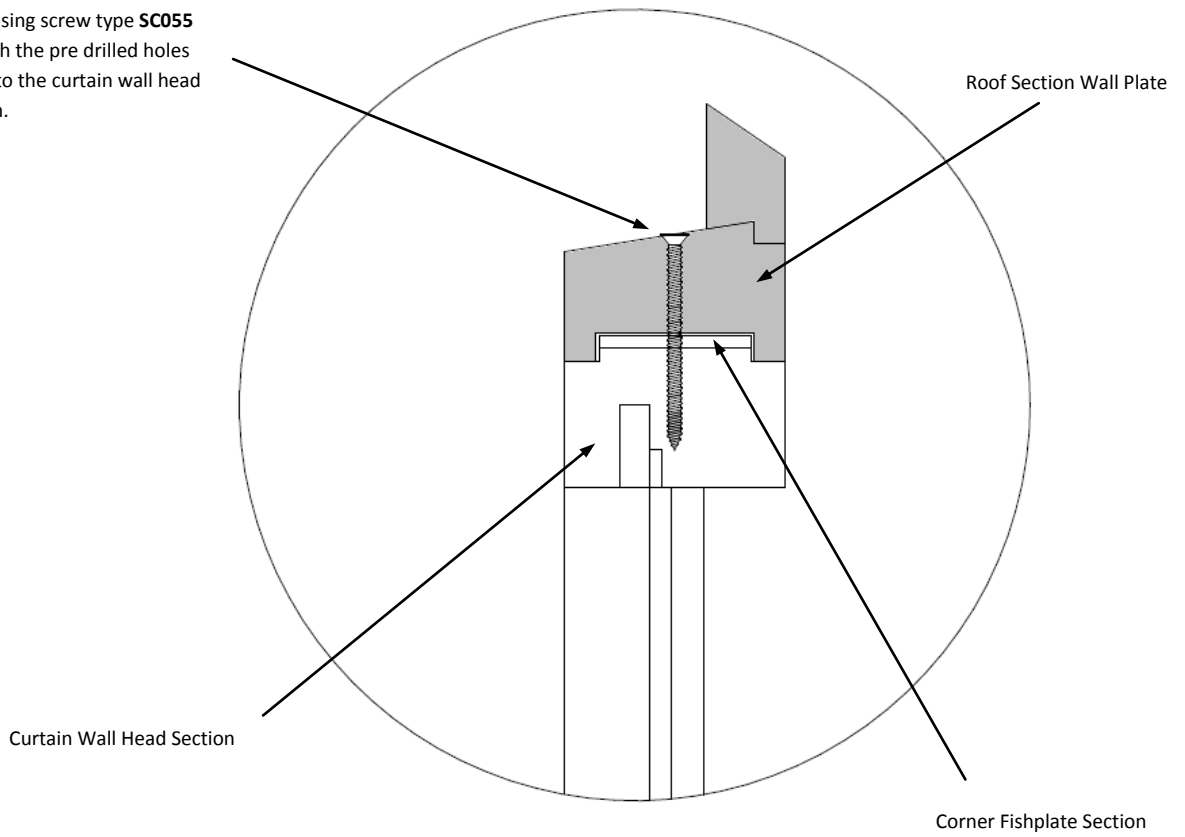

Fix wall plate corners together using screw type **SC057**

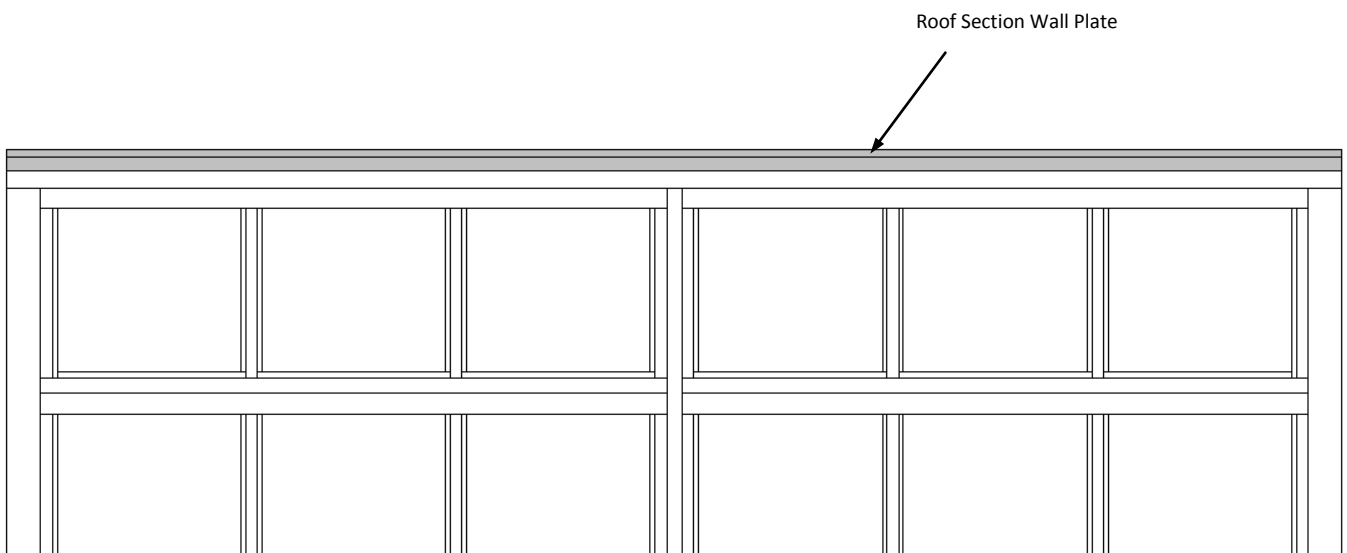

Assemble and fix the Portal Frame

A portal frame is required at each joint in the curtain wall. The Portal frame is fixed together using the supplied fish plates fixed on either side of the portal frame profile.

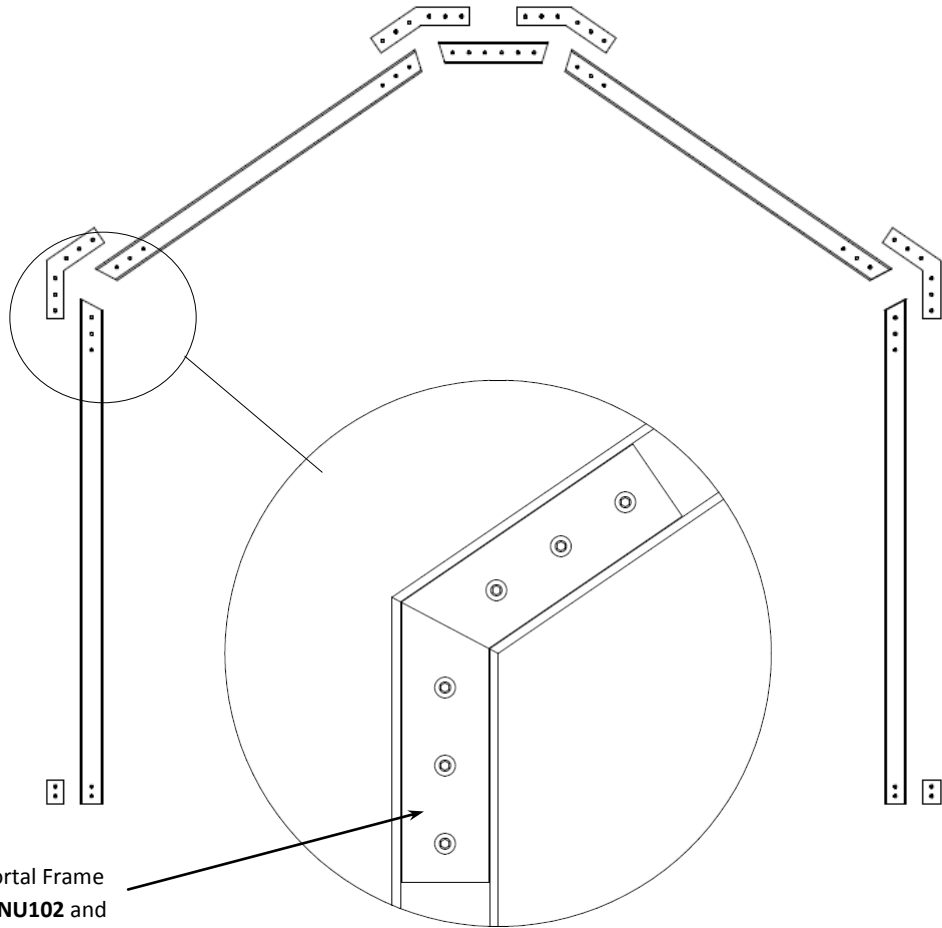

Fix the Fish Plates to Portal Frame using Bolt Type **BL153**, **NU102** and **WA205**.

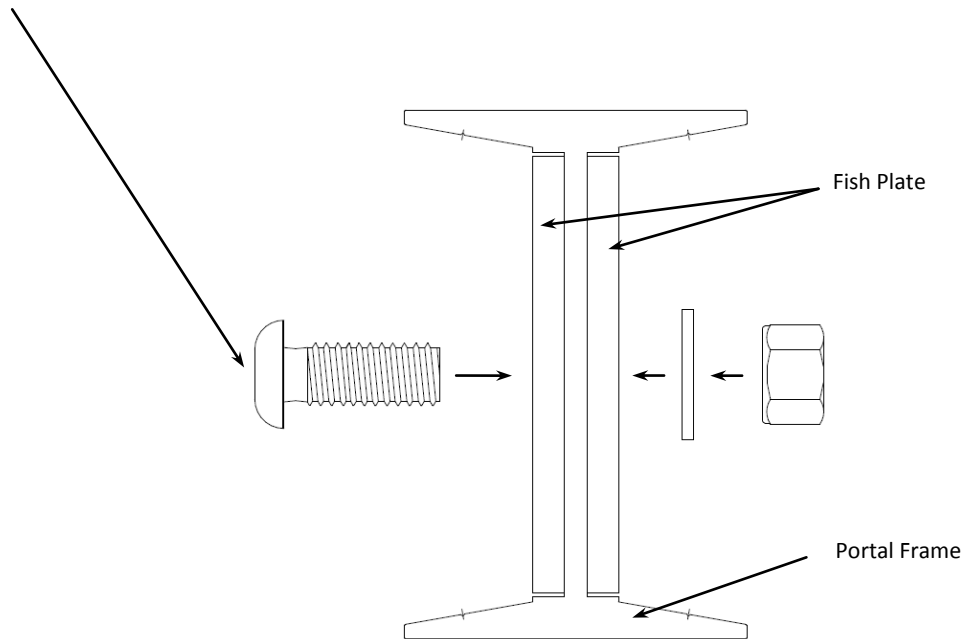

Fit the Portal Frame into Position

Locate the portal frame at the joint between the curtain walls.

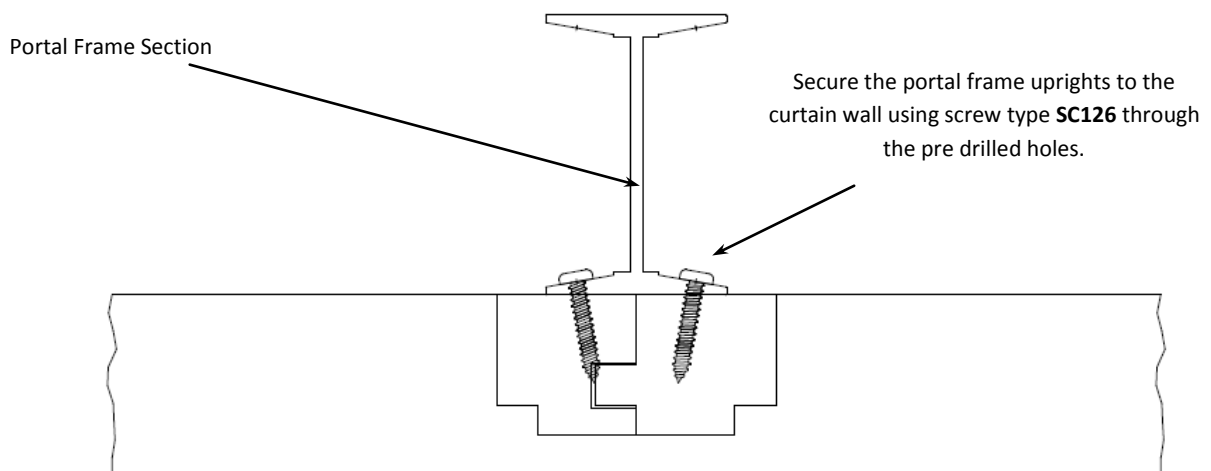
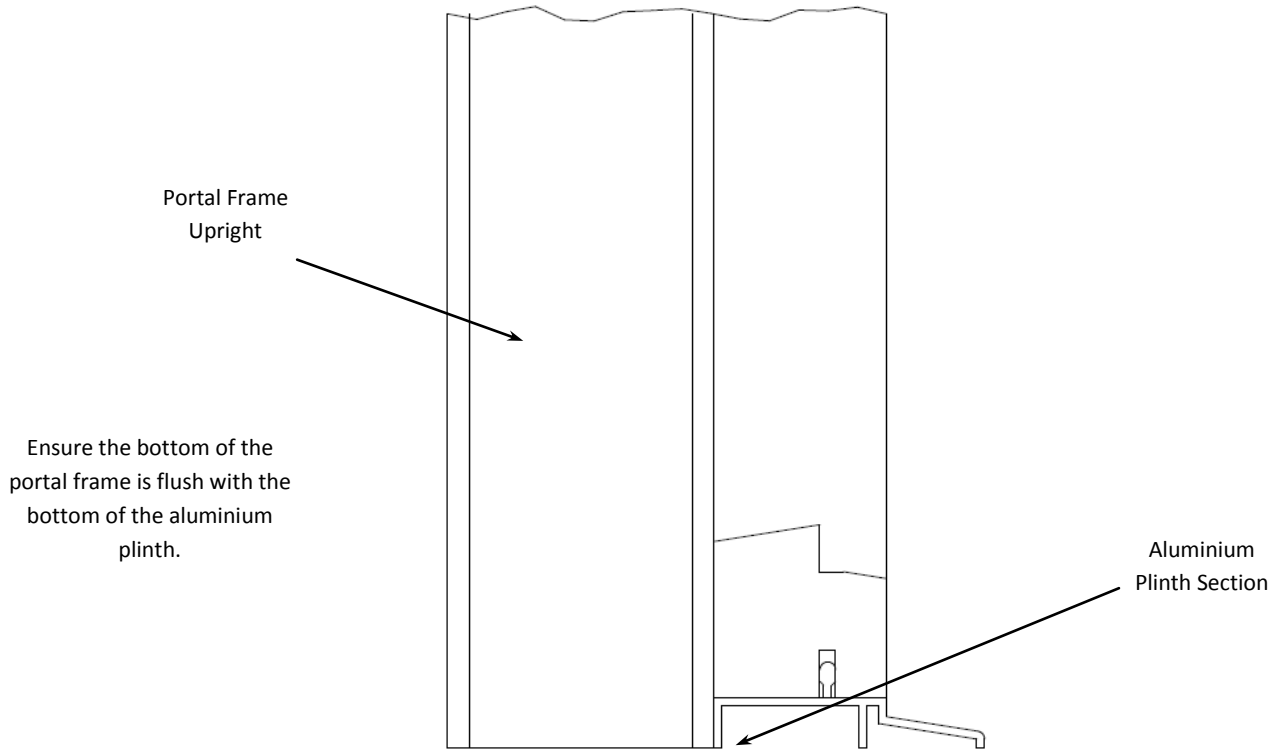

Fix the Roof Spars to Ridge

Working in pairs, position the roof spars onto the roof section wall plates and the top end onto the ridge. Fix using screw type SC054.

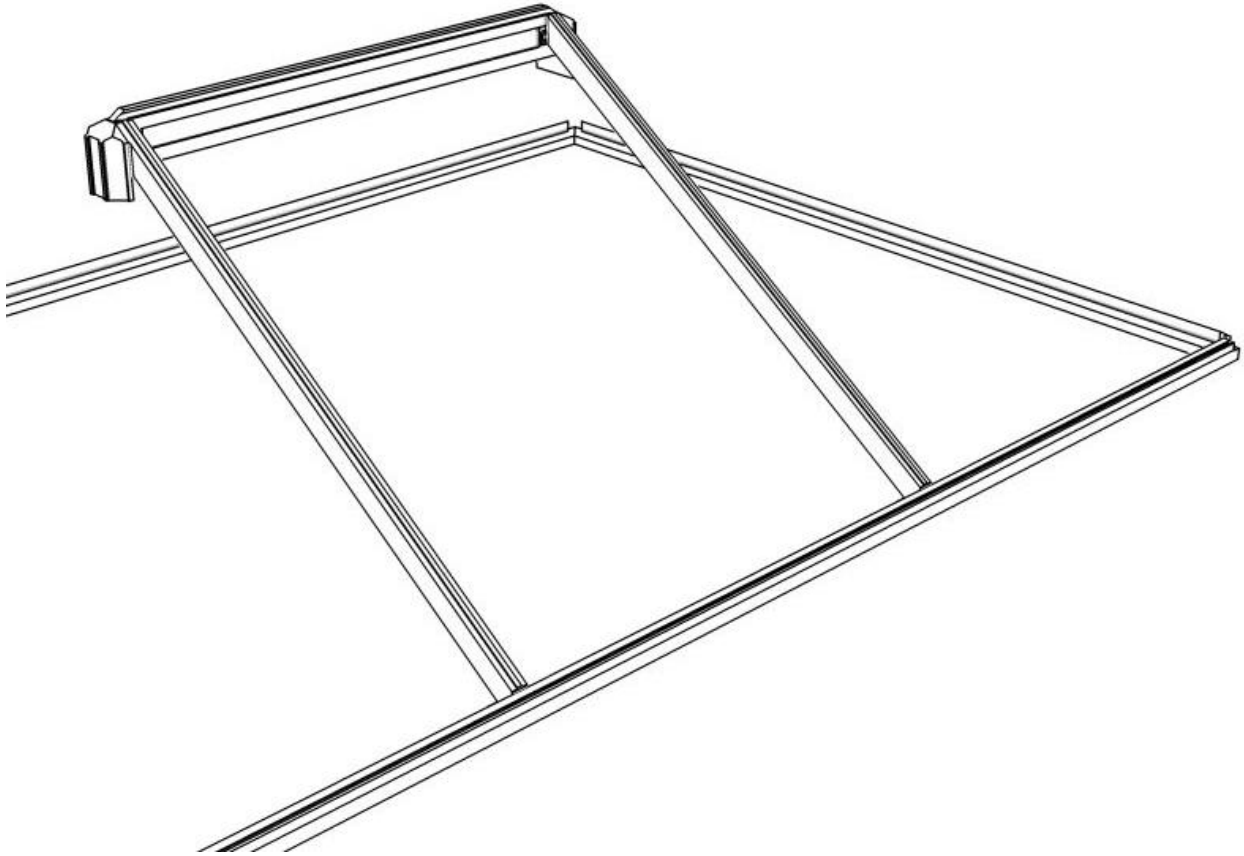

Fix this spar and its opposite using screw type **SC054**. Position the top end against the spider block and the bottom onto the roof section wall plate.

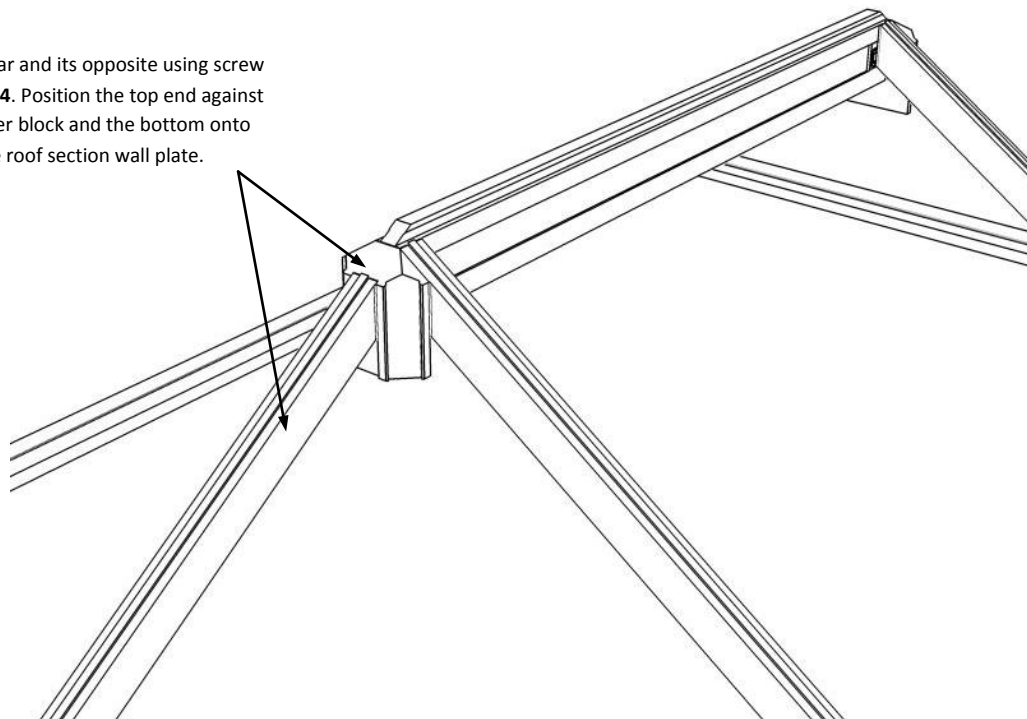

Fix Hip Bars to Roof Section Wall Plates and Spider Block.

Working in opposite pairs, position the hip bar into the inside corner of the curtain walls onto the roof section wall plates and the top end onto the Spider Block. Fix using screw type SC056.

The Bottom End which fits into the corner and fixed to the wall plate using screw type SC056.

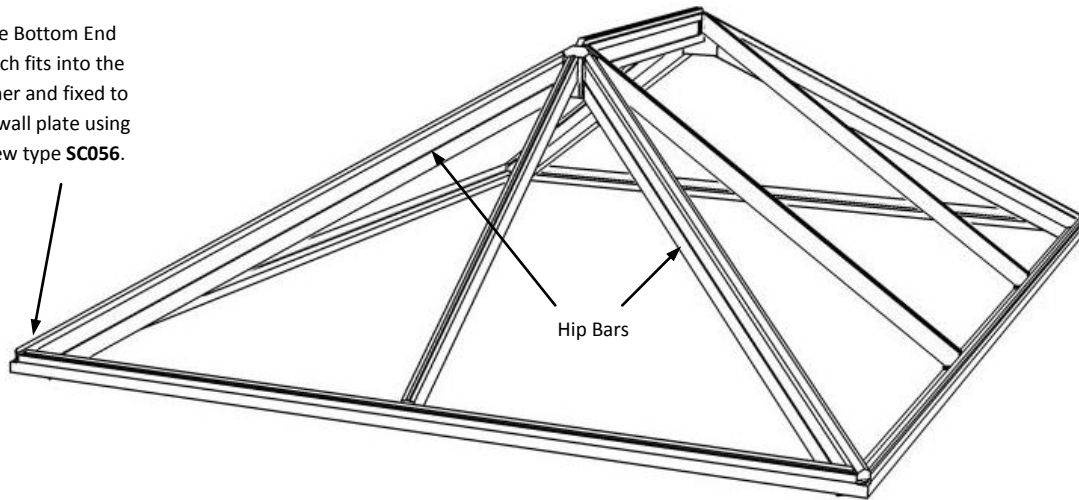

Hip Bars

The Top End which fits onto the spider block using screw type SC056.

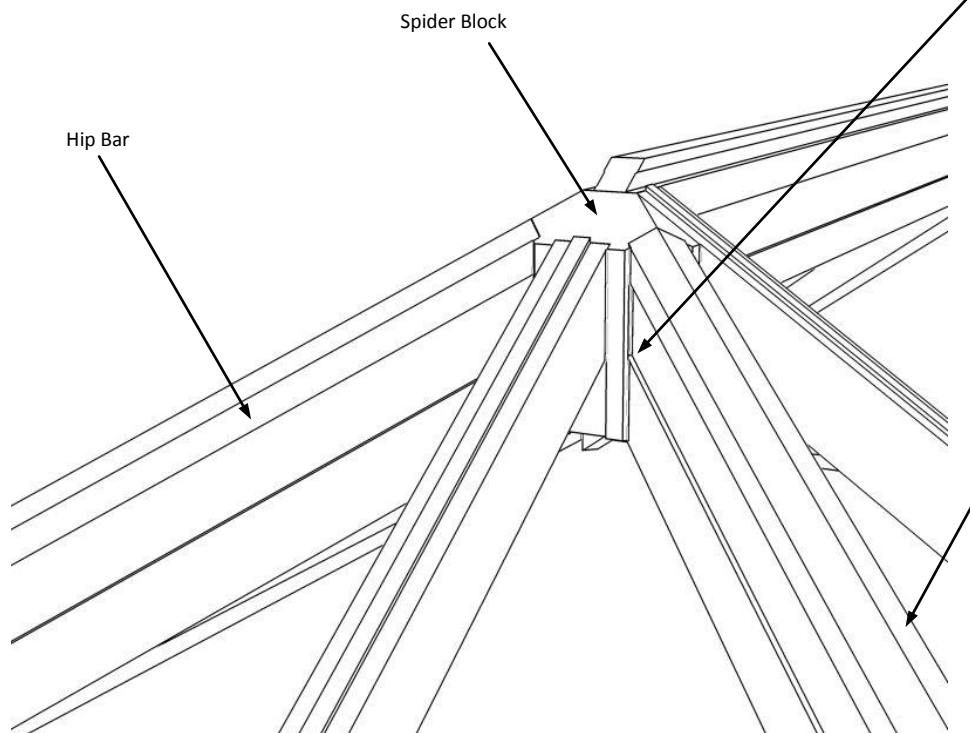

Hip Bar

Spider Block

The top faces of the hip bars are machined at an angle. These faces must finish flush with the top faces of the spider block.

Fix Jack Spars to Roof Section Wall Plates and Hip Bars.

The Jack Spars are supplied in pairs. They have a fixing plate pre-fixed at their upper end which locates into the groove machined onto the sides of the hip bars. Fix the plates into the hip bars using screw type **SC054**.

The lower ends of the spars are located into the spaces in the wall plate so that the bottom cut is flush with the outside face of the wall plate and fix using screw type **SC057**.

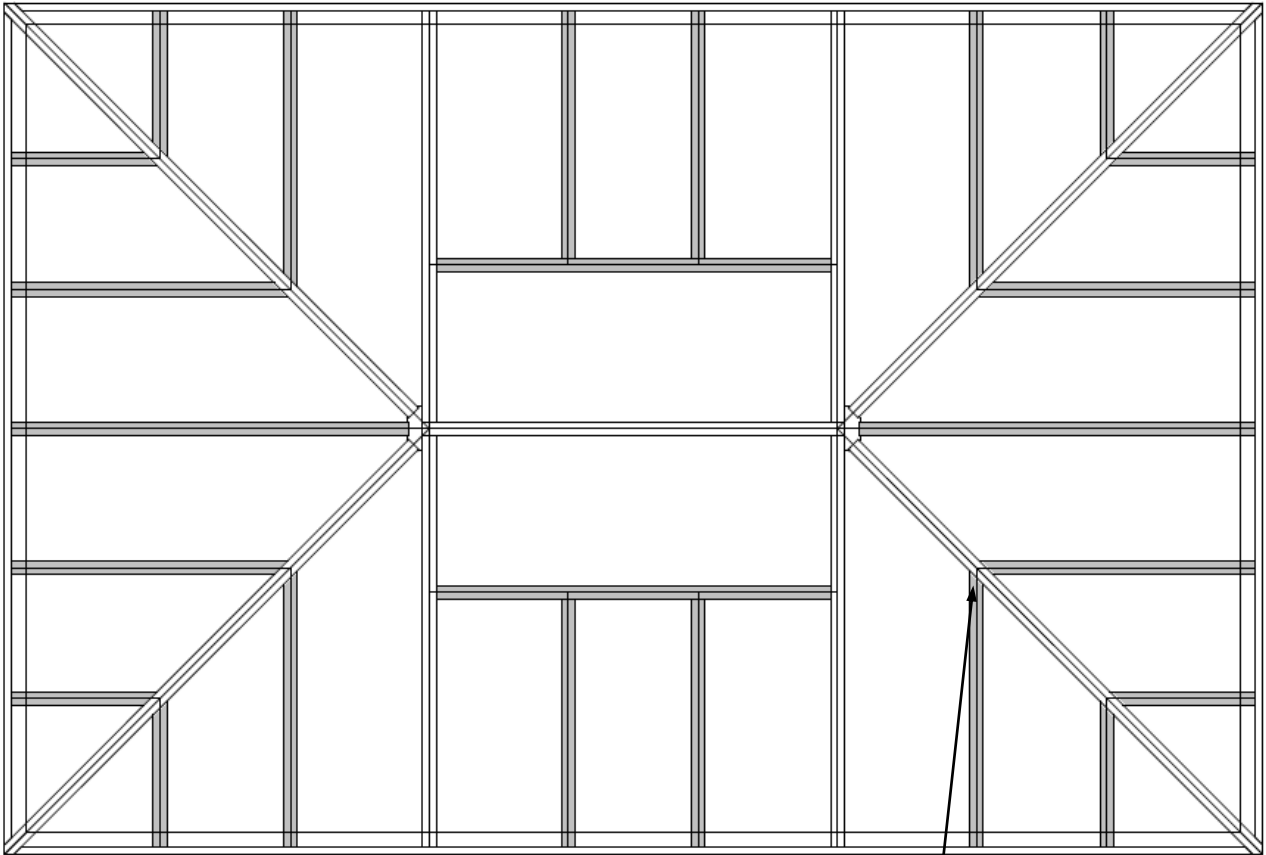

Plan View

The top faces of the Jack spars should be flush with the top angled face of the hip bar.

Position and Fix Glass Stops

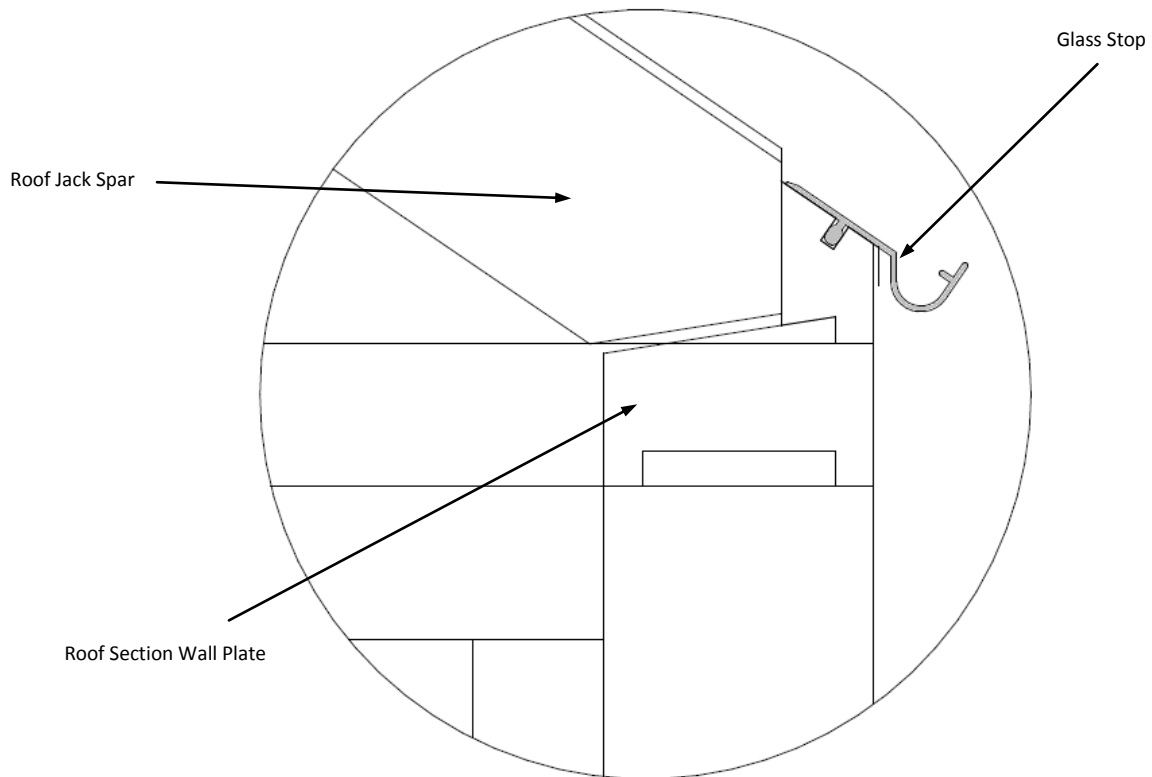

Firmly push the glass stop into the groove on the roof section wall plate.

Repeat for remaining sides around the structure.

Please Note: At a later stage when fixing the jack spar cappings, the bottom pre drilled holes of the capping should align with the pre drilled holes in the glass stops.

Assemble and Fit Vent and Fix Autovent

Firstly fix this 'H Transome' to the lower vent transome using a mastic gun.

Ridge Centre Section

Outer Vent Cover Section

Inner Vent Cover Section

Roof Capping Section

Vent Transome Section

Plan View

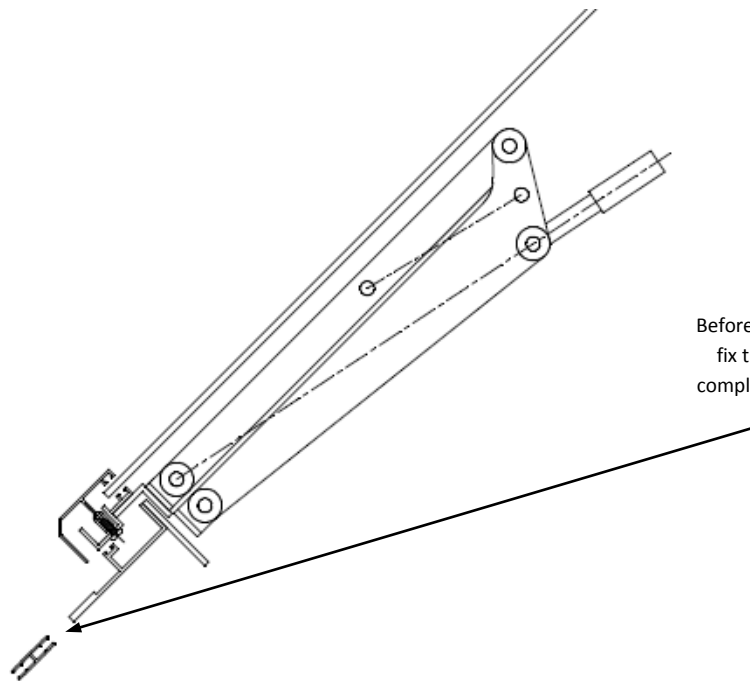
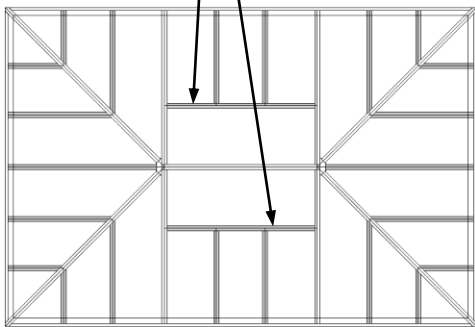

Before securing the vent assembly in position, fix the auto vents to vent assembly. Once complete, position the vent assembly into the 'H Transome'.

Roof Glass Reference

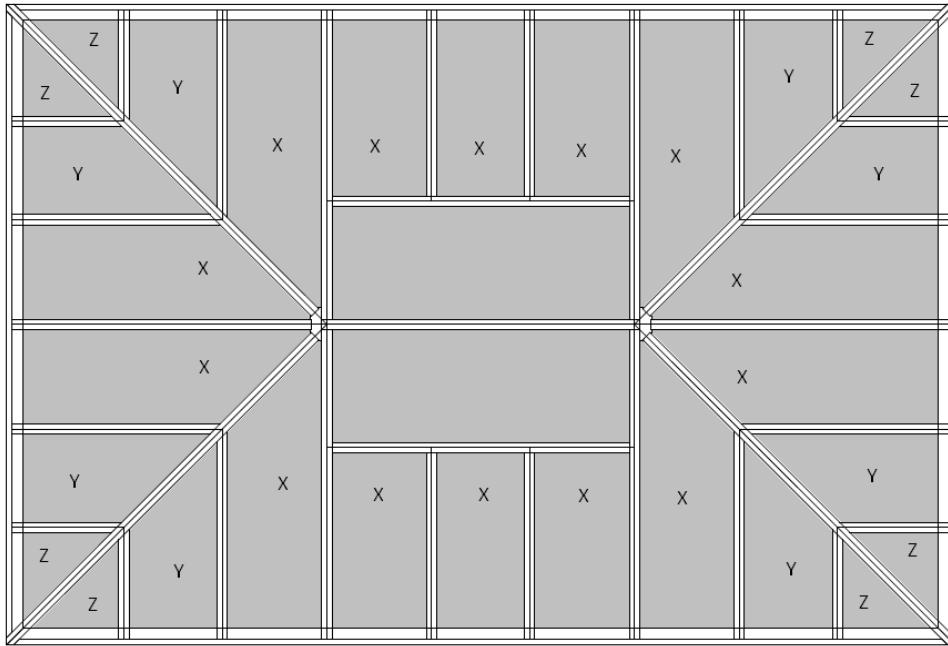

Fit Glass 'X'

Position all of Glass Pane X and rest on glass stop at bottom and the top part of the pane into the bottom of the 'H Transome'.

Fit Lower Ridge Cover

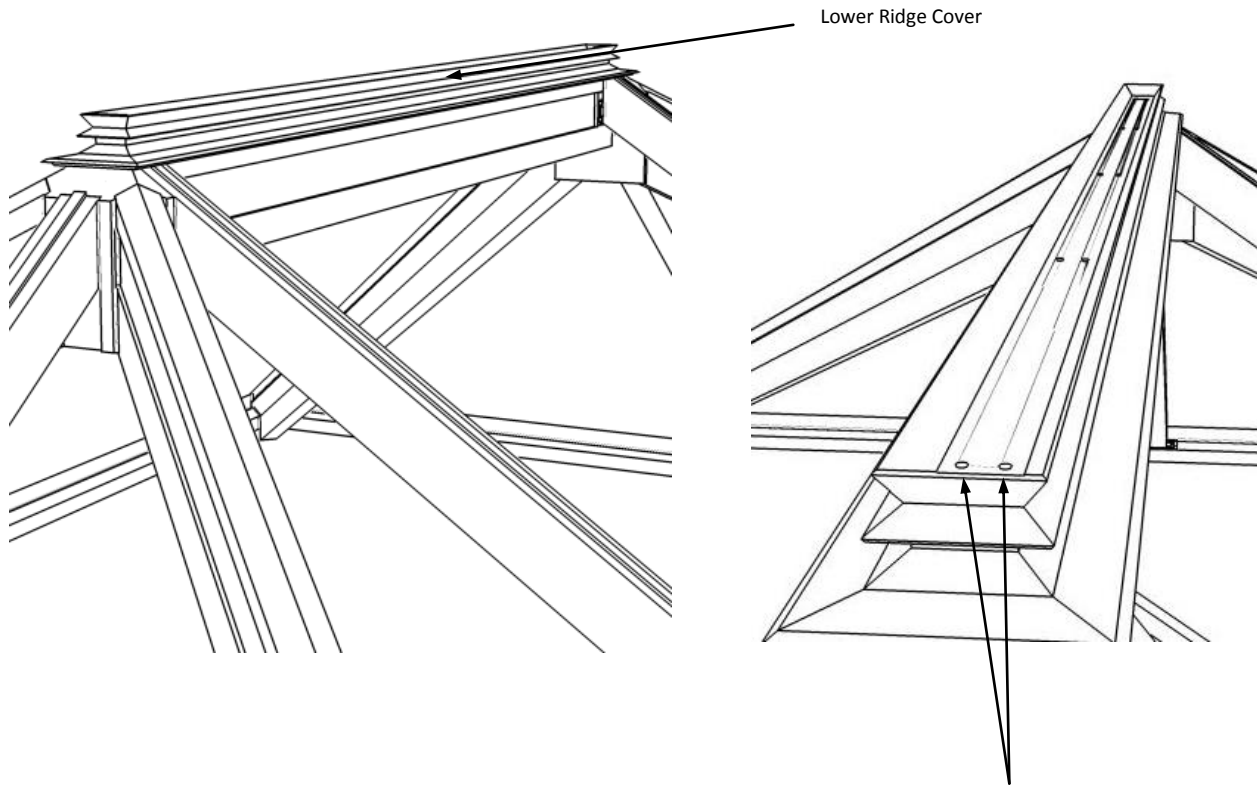

Fit Upper Ridge Cover

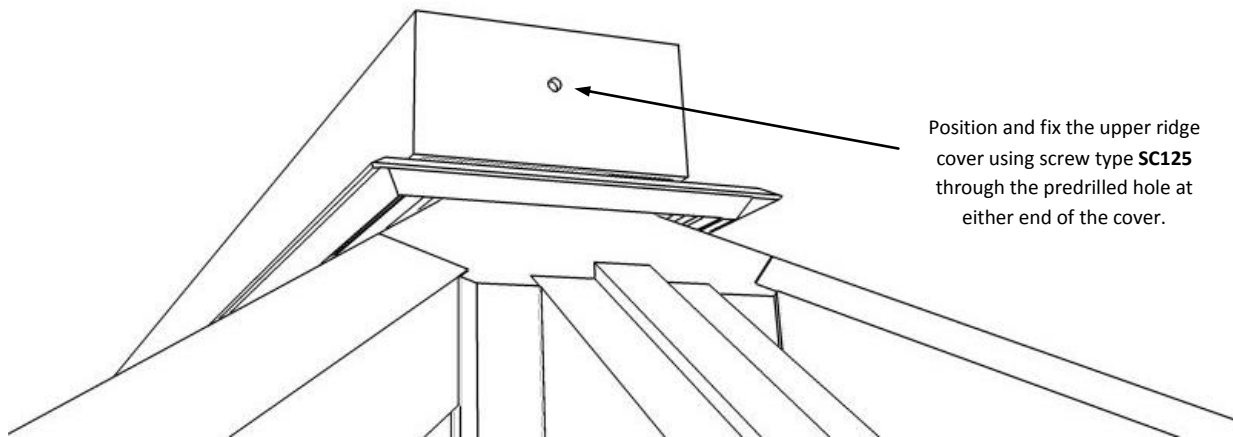

Position and fix the lower ridge cover using screw type **SC125** through the predrilled holes and into the ridge.

Fix Hip Cappings

Ensure gaskets are tight up against lower ridge cover and as a temporary measure fix the top screw only.

Please Note: Ensure the capping remains positioned centrally over the hip spars.

Seal the top end of hip capping underneath the lower ridge cover with Arbo seal.

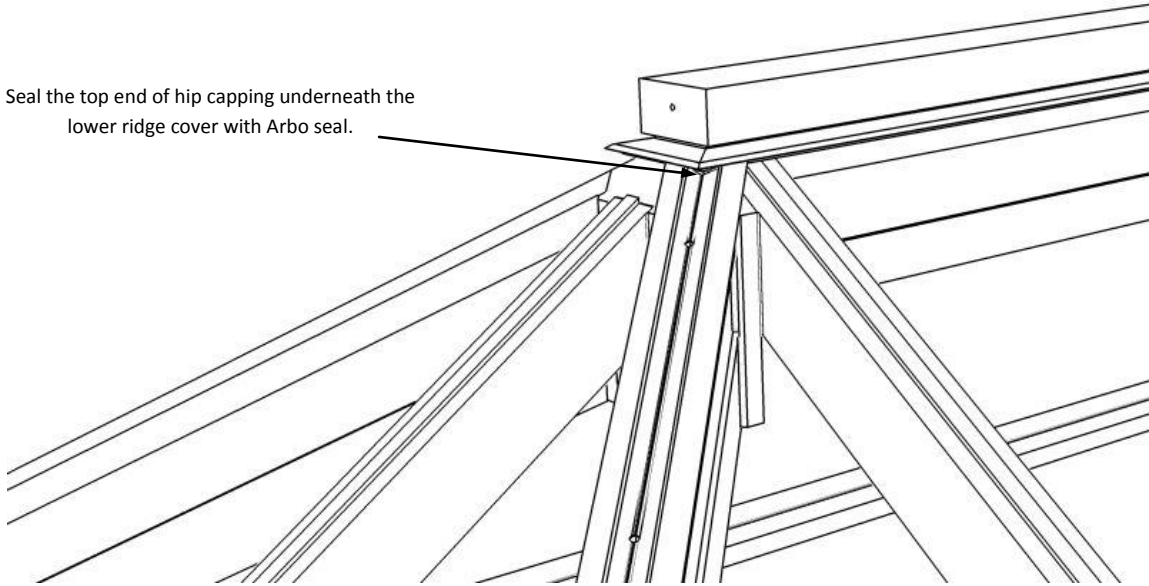

Repeat for all four Hips.

Now Fix Glass Shapes Y and Z

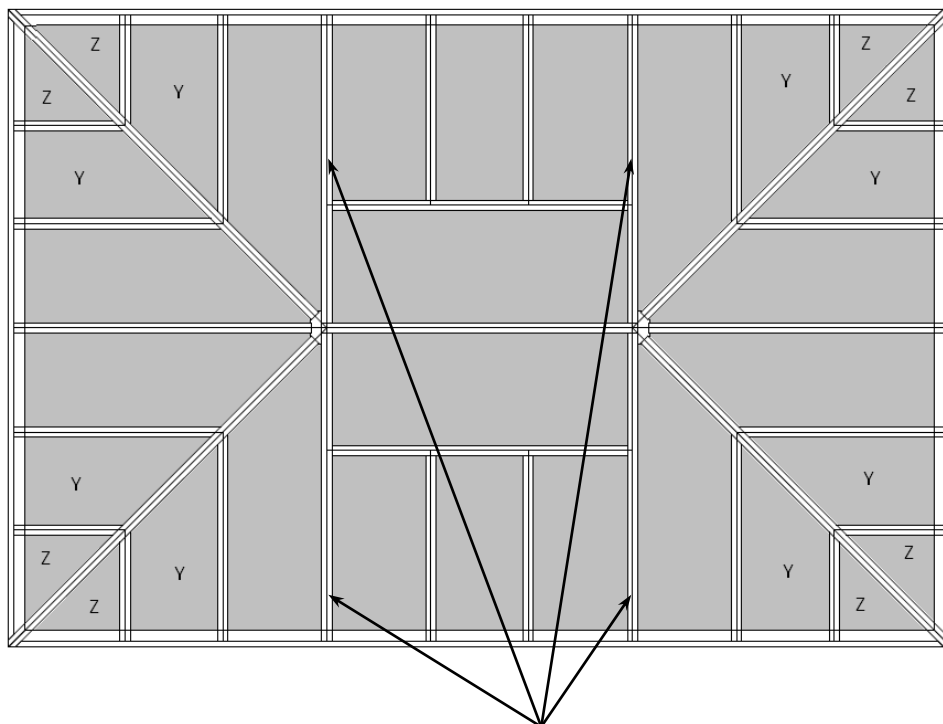

Capping 'A'

Fix Jack Spar Capping and Apply Arbo Seal

Fix the aluminium capping to all of the jack spars with the exception of 'Capping A' which is labelled in the previous diagram.

Ensure the top of capping is tight up to and fits under the lip of the hip capping.

Before fitting 'Capping A' apply arbo seal down the side of the roof vent to 100mm below the 'H' transome. Repeat for both sides.

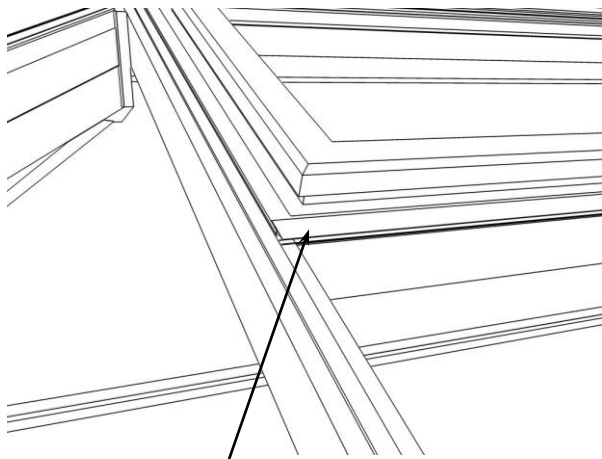

'H' Transome

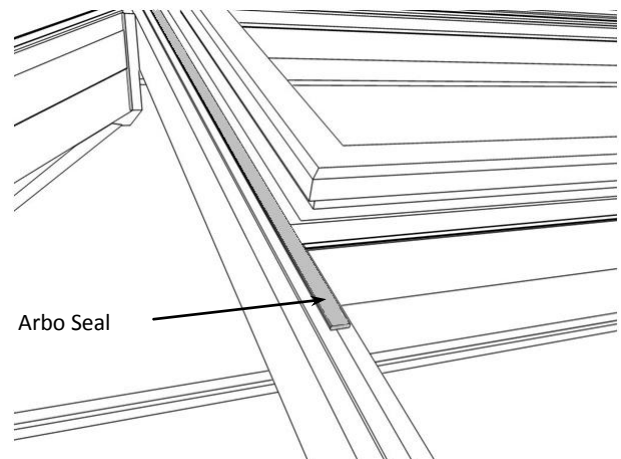

Arbo Seal

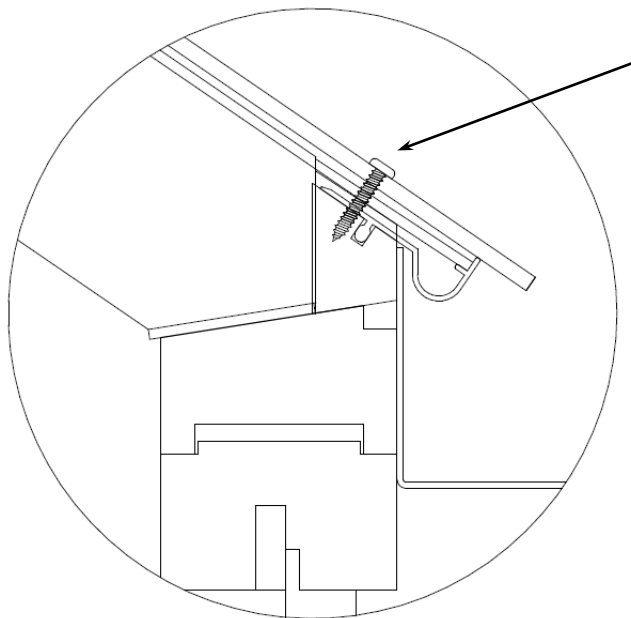

The bottom pre drilled holes of the capping should align with the pre drilled holes in the glass stops. Using screw type **SC125** position the screw into the capping and fix through glass stop and into the roof wall plate.

If the holes do not align, we recommend using a 3.5mm drill bit to drill a new hole through the glass stops using the capping as a guide.

Take care not to drill too deeply into the timber roof wall plate.

Apply arbo seal to the underside of the capping where the capping fly's over the H transome underneath the roof vent.

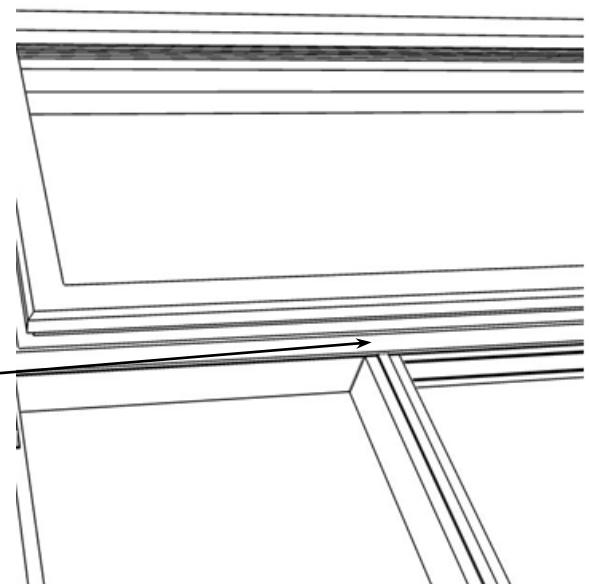

Position and Fix Gutters

Starting at the door end, position the gutter up against the underside of the glass stop and using the brackets supplied, rest the gutter on brackets and fix through the pre drilled hole into the curtain wall head section using screw type **SC123**.

Position 4 brackets evenly along the 9 panel side and 3 brackets along the 6 panel ends. The brackets should line up with the mullions.

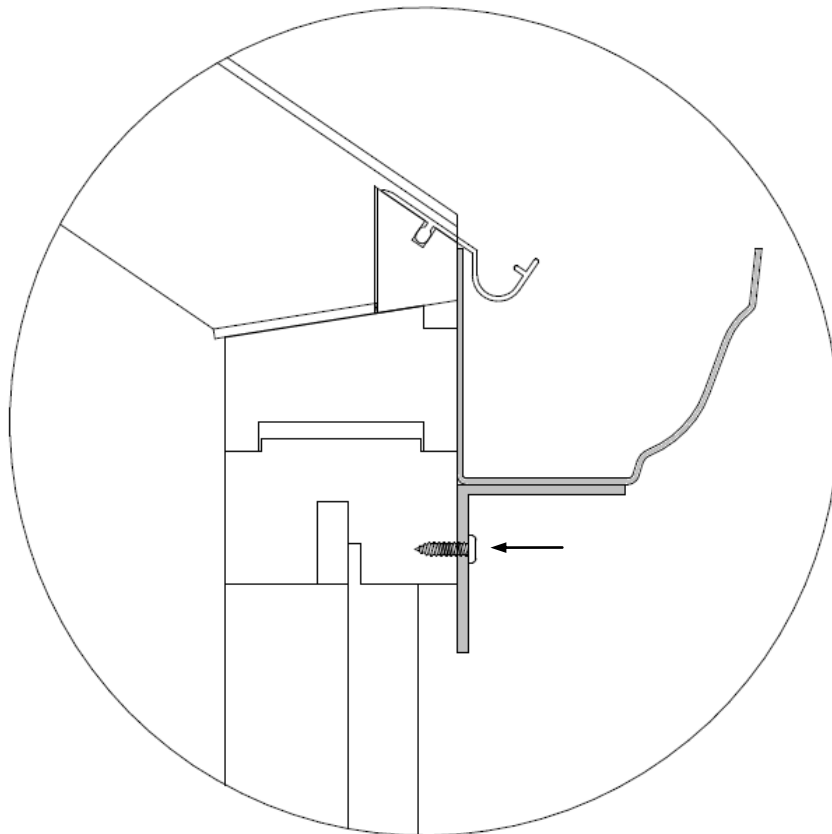

Glazing the Sides

Remove all timber capping making a note of where they came from.

Locate the top of the glass pane in the groove in the top rail and rest on bottom edge of cill. Refit all capping making sure they are pushed tight up to the underside of the top rail and re-fix using the brass screws and washers you removed.

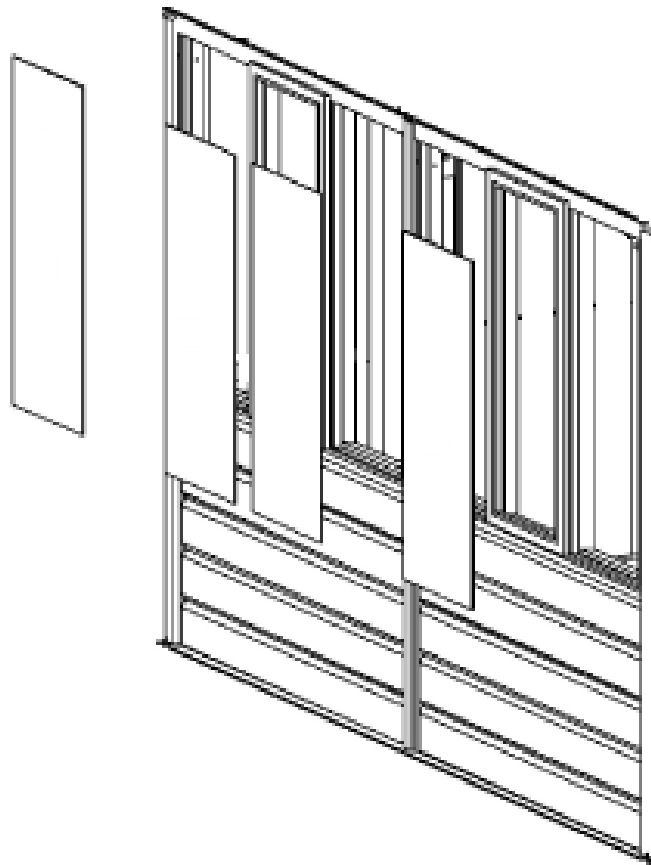

Repeat for all sides.

Fix Structure to Base

Use a 9mm HSS drill to go through the timber base rails and aluminium plinths and a 8mm x 150mm long masonry drill to go into the brickwork to a depth of 110mm.

Use screw type **SC058**, washer type **WA501** and fixing **FX200**.

Ensure Fixings are not on brick joints.

